

DISTRICT REQUIREMENTS FOR THE INSTALLATION OF HOUSE SEWERS

- A specific District Permit is required for all sewer work outside of the building.
- Any work to be done within a public right of way, by lay, must be accomplished by a licensed underground contractor
- Approved materials in the District are: Vitrified Clay Pipe (VCP), Coal Tar Epoxy Coated Ductile Iron Pipe (DIP), Cast Iron Pipe (CIP), Schedule 80 PVC, DR 14 C900 PVC and DR17 High Density Polyethylene pipe (HDPE) (for pipe bursting applications only). **No other Plastic Pipe of any other type is allowed. NO ABS!**
- DIP or CIP must be used where pipeline cover of less than thirty (30) inches of cover is anticipated or planned in paved or traffic areas.
- Minimum pipe size for house sewers is four (4) inches inside diameter (except for pressure pipe from house ejector pumps where 3" inside diameter pipe is required for house sewers. (e-one pump discharge is 1 ¼" I.D.)
- Minimum fall (slope) is two (2) percent or one-quarter (1/4) inch drop per foot of run.
- All trenches for sewers must be protected and shored in accordance with District requirements and existing State Safety Laws in effect at the time the work is started or in progress. All trenches greater than five (5) feet in depth must be shored in accordance with State Safety Laws.
- **All connections in the public right of ways and driveways shall be made using Mission Clay ARC Connectors (or approved equal.)**
- All pipe shall require a uniform trench bottom of ¾" **ANGULAR DRAIN ROCK** 4" thick. Bell holes for pipe joints are required for all pipe installations
- No backfill or bedding shall be placed over the pipe until the pipe has been inspected by the District Inspector or authorized District representative.
- Inspections must be arranged with the **District Inspector** at least twenty-four (24) hours prior to commencing the work. (Otis Ward, 510-222-6700 Ext. 3627)
- No other utility service or drainage pipelines, conduits or cables are permitted in the trench with the sewer.
- All backfill over one (1) foot above the pipe within the public streets must be one hundred (100) percent Class II A.B. or must be approved by the appropriate Public Agency.
- Unless specifically directed by the District Inspector, the installation of building sewers shall conform to the 2006 Uniform Plumbing Code (U.P.C.), Chapters 4 and 11, or related District Ordinances and Standard Detail.
- Cleanouts must be installed at the connection of the house sewer and the building drain, within two (2) feet of the building foundation. Additional cleanouts shall be installed at intervals not to exceed one hundred (100) feet in straight runs and for each aggregate change in direction

SEWER CLEANOUT & BACKFLOW PREVENTER
REQUIRED FOR ALL CONSTRUCTION

exceeding one hundred and thirty five (135) degrees or at any single turn of ninety (90) degrees or more.

- A sewer cleanout backwater overflow device & Clean Check® check valve are required for ALL construction (unless an exception is granted by the District Inspector), including but not limited to, repairs, new connections and additions.
- Side or house sewers are subject to video inspection (provided by contractor).
- **NO "HAMMER TAP" CONNECTIONS WILL BE ALLOWED TO REMAIN.**
- **Any existing 6" laterals shall be replaced with 6" lateral. This is common in Rollingwood.**
- Note that there are multiple examples of shared laterals in Mac Arthur Villa. If a lateral exits the property at the shared property line, there is likely a shared lateral. Be sure to reconnect the neighbor.
- Underground Service Alert (USA), (800) 642-2444, must be called at least forty-eight (48) hours prior to any excavation.

REQUIREMENTS FOR CONSTRUCTION ON REPAIRS TO EXISTING LATERALS

1. Normally work should remain confined to working in the same location of the existing lateral.
2. If work requires construction of a new lateral in a new location and abandoning of the existing lateral in place, **the abandoned lateral must be removed at the main line.** Abandoned sections of lateral must not remain attached to the main line, at the connection to the main line must be replaced with a straight piece of pipe by the permit holder. If a manufactured "Y" was present, an ARC style coupling with a clay or cast iron plug is acceptable to seal the mainline.
3. Only Vitrified Clay Pipe (VCP), Ductile Iron Pipe (DIP), Cast Iron Pipe (CIP), Schedule 80 PVC, DR 14 C900 PVC or DR17 High Density Polyethylene pipe (HDPE) (for pipe bursting applications only) is acceptable for lateral repair/replacement. Generally the same material of the existing lateral should be used for any repairs.
4. DR 17 HDPE pipe may be used for pipe bursting replacement of a lateral. Pipe bursting applications will be approved on a case by case basis. Adequate slope must be demonstrated by video inspection.

<p>West County Wastewater District 2910 Hilltop Drive, Richmond, CA 94806</p> <p>Michael Allendorfer, District Inspector BUS (510) 662-3627 FAX (510) 222-3277</p>	<p>SEWER CLEANOUT & BACKFLOW PREVENTER REQUIRED FOR ALL CONSTRUCTION</p>
--	---

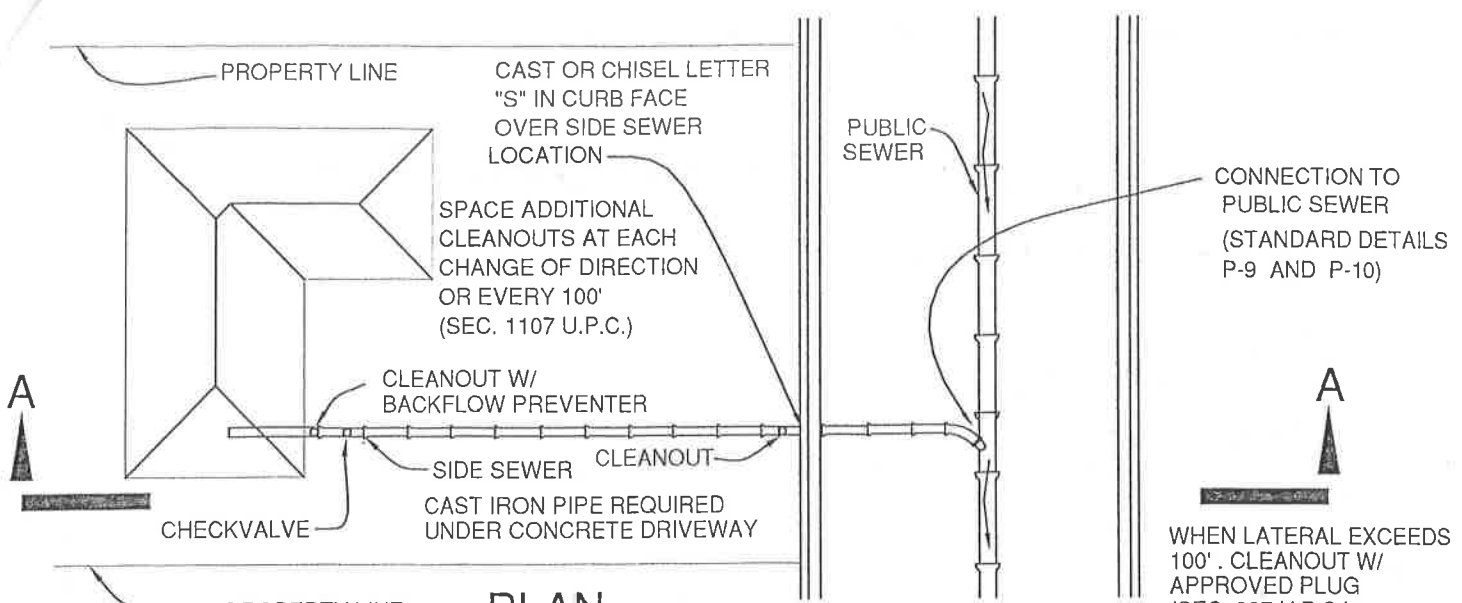

PLAN

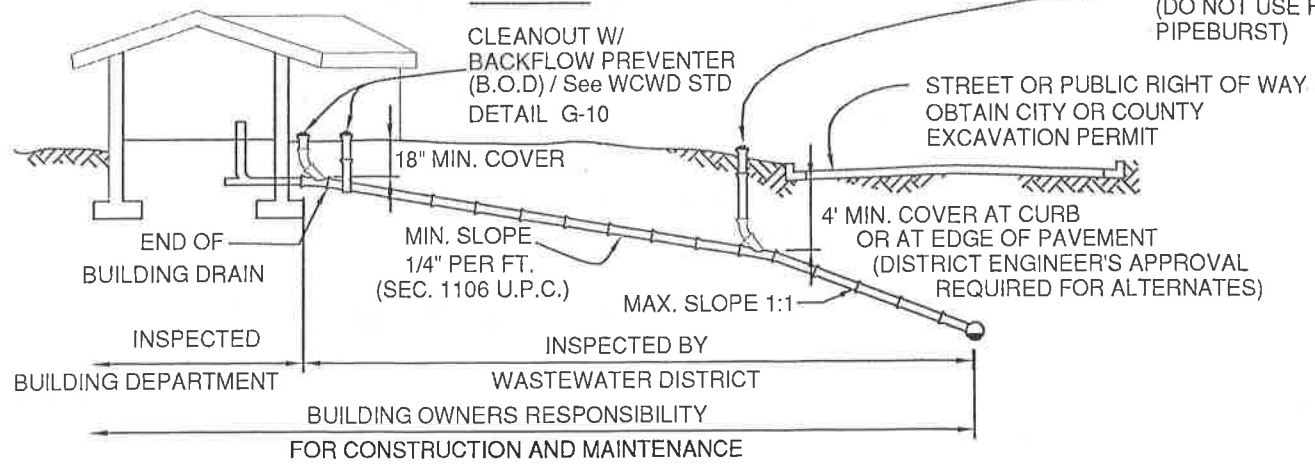

SECTION A-A

SIZING TABLE

USE	MIN. DIAM.
ONE SINGLE-FAMILY DWELLING	4 IN.
TWO OR MORE SINGLE-FAMILY DWELLINGS	6 IN.
MULTIPLE DWELLINGS AND TRAILER COURTS (LESS THAN SIX UNITS)	4 IN.
MULTIPLE DWELLINGS AND TRAILER COURTS (SIX OR MORE UNITS)	6 IN.
COMMERCIAL, INDUSTRIAL AND INSTITUTIONAL BUILDINGS	6 IN.
COMMERCIAL, INDUSTRIAL AND INSTITUTIONAL BUILDINGS (gpd > 118,000gpd)	8 IN.

FOR FURTHER PIPE SIZING CONSIDERATIONS SEE SEC. 1105 I.A.P.M.O. UNIFORM PLUMBING CODE

CONNECTION TO SEWER MAIN

SIDE SEWER DIAMETER	SEWER MAIN DIAMETER		
	6 IN.	8 IN.	10 IN. OR LARGER
4 IN.	WYE	WYE	AS DETERMINED
6 IN.	WYE	WYE	AS DETERMINED

NOTES

1. APPROVED MATERIALS ARE C-900-DR 14 PVC, VITRIFIED CLAY PIPE AND CAST IRON PIPE AND JOINTS, IN ACCORDANCE WITH THE I.A.P.M.O. UNIFORM PLUMBING CODE.
2. ALL BUILDINGS ON SLOPE MUST HAVE BACKFLOW PROTECTION DEVICE INSTALLED.
3. COMMERCIAL, INDUSTRIAL AND INSTITUTIONAL BUILDINGS SHALL HAVE AN OIL SEPARATOR OR GREASE TRAP AS DIRECTED (SEE STANDARD DETAIL G-4)
4. LOW AIR PRESSURE TESTS WILL BE REQUIRED ON ALL NEW PIPELINE INSTALLATIONS. PIPE BURST - SIDE SEWERS WILL BE INSPECTED VIA CLOSED CIRCUIT VIDEO.

Approved By: 
KENNETH R. COOK, PE
 ENGINEERING SERVICES MANAGER

WEST COUNTY WASTEWATER DISTRICT

DRAWN BY: M. MCNEIL
DATE: Sept, 2015

SIDE SEWERS

STANDARD
DETAIL G-5